

TC ELECTRONIC RUSTY FUZZ

Silicon-Based Transistor Fuzz with Vintage Gated and Velcro-Like Fuzz Tones

Quick Start Guide

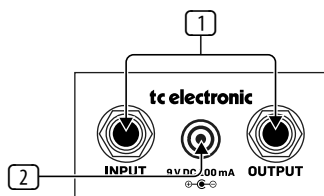
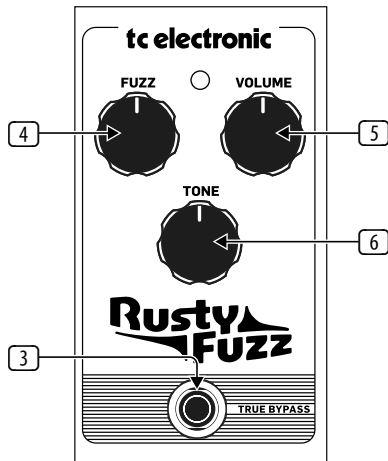

EN Controls

- 1 **Input/Output jacks** – Connect a 1/4" cable from your guitar to the INPUT jack, and connect a cable from the OUTPUT jack to your amplifier.
- 2 **9 VDC** – Connect a 9 V power supply (not included).
- 3 **Footswitch** – Turns the effect on and off. The LED will light when the pedal is engaged. The pedal operates in true bypass when disengaged.
- 4 **Fuzz** – Adjusts the amount of distortion.
- 5 **Volume** – Adjusts the output level when the pedal is engaged.
- 6 **Tone** – Adjusts the amount of high frequency contour for a brighter or rounder sound.

ES Controles y conectores

- 1 **Tomas de entrada/salida (Input/Output)** – Conecte un cable con clavijas de 6,3 mm desde su guitarra a la toma INPUT y otro cable desde la toma OUTPUT al amplificador.
- 2 **9 VDC** – Conecte un adaptador de corriente de 9 V (opcional).

- 3 **Pedal (Footswitch)** – Esto activa y desactiva el efecto. El piloto se iluminará cuando el pedal esté activo. Cuando no esté activo, este pedal ofrece un bypass real.
- 4 **Fuzz** – Ajusta la cantidad de distorsión.
- 5 **Volume** – Ajusta el nivel de salida cuando el pedal no está activo.
- 6 **Tone** – Ajusta la cantidad de modelado de altas frecuencias para ofrecerle un sonido más brillante o más suave.

FR Réglages et connecteurs

- 1 **Entrée et sortie** – Connectez un câble Jack 6,35 mm entre votre guitare et l'entrée de la pédale. Connectez également un câble entre la sortie de la pédale et l'entrée de votre ampli.
- 2 **9 VDC** – Permet de connecter un adaptateur secteur 9 V (non fourni).
- 3 **Contacteur au pied** – Permet d'activer/désactiver l'effet. La LED s'allume lorsque la pédale est activée. Lorsque l'effet est désactivé, la pédale fonctionne en true bypass.
- 4 **Fuzz** – Permet de régler la quantité de distorsion.
- 5 **Volume** – Réglage du volume de sortie lorsque la pédale est activée.
- 6 **Tone** – Réglage du contour des hautes fréquences afin d'obtenir un son plus brillant ou plus rond.

DE Regler und Anschlüsse

- 1 **Eingang-/Ausgangsbuchsen** – Schließen Sie das 6,3 mm-Kabel Ihrer Gitarre an die INPUT-Buchse an und verbinden Sie die OUTPUT-Buchse über ein weiteres Kabel mit Ihrem Verstärker.
- 2 **9 VDC** – Schließen Sie hier einen optionalen 9 V Netzadapter an.
- 3 **Fußschalter** – Schaltet den Effekt ein und aus. Bei aktiviertem Pedal leuchtet die LED. Bei deaktiviertem Pedal wird das Signal vollständig am Pedal vorbeigeführt (echter Bypass).
- 4 **Fuzz** – Regelt die Stärke der Verzerrung.
- 5 **Volume** – Regelt den Ausgangspegel bei aktiviertem Pedal.
- 6 **Tone** – Regelt die Betonung des hohen Frequenzbereichs für einen helleren und runderen Sound.

PT Controles e Conectores

- 1 **Jacks Input/Output** – Conecte um cabo de 1/4" da sua guitarra ao jack INPUT, e conecte um cabo do jack OUTPUT ao seu amplificador.
- 2 **9 VDC** – Conecte uma fonte de alimentação de 9 V (não inclusa).
- 3 **Footswitch** – Liga e desliga o efeito. O LED acenderá quando o pedal estiver ativado. O pedal opera em true bypass quando desativado.
- 4 **Fuzz** – Ajusta a quantidade de distorção.

- 5 **Volume** – Ajusta o nível de saída quando o pedal está acionado.
- 6 **Tone** – Ajusta a quantidade do contorno de alta frequência proporcionando um som mais agudo ou mais redondo.

IT Controlli

- 1 **Input/Output jacks** – collegare un cavo con jack da 6,35mm dalla chitarra alla presa INPUT e un cavo dalla presa OUTPUT all'amplificatore.
- 2 **9 V DC** – connessione per alimentatore da 9V (non fornito).
- 3 **Footswitch** – attiva e disattiva l'effetto. Il led si accende quando il pedale è attivo. Il pedale funziona "true bypass" quando non è attivo.
- 4 **Fuzz** – regola la quantità di distorsione.
- 5 **Volume** – regola il livello di uscita quando il pedale è attivo.
- 6 **Tone** – regola la quantità di "contour" delle frequenze alte per un suono più brillante o più rotondo.

JP コントロール類およびコネクター類

- 1 **Input/Output (入力/出力) ジャック** – 1/4 インチケーブルを使って、ギターを入力 (INPUT) ジャックに接続し、出力 (OUTPUT) ジャックとお使いのアンプリファイアを接続します。
- 2 **9 V DC** – 9V パワーサプライ (別売) を接続します。
- 3 **Footswitch (フットスイッチ)** – エフェクトのオン/オフをおこないます。ペダルの有効時は LED が点灯します。ペダルの無効時はトゥルーバイパスとなります。
- 4 **Fuzz (ファズ)** – 歪みの量を調節します。
- 5 **Volume (ボリューム)** – ペダル有効時の出力レベルを調節します。
- 6 **Tone (トーン)** – 音色を明るく/またはまるやかにする、高域のコンター EQ を調節します。

CN 控制和接口

- 1 **Input/Output 接口** – 连接吉他的 1/4" 线到 INPUT 接口, 将插入 OUTPUT 接口的线连接到功放。
- 2 **9 V DC** – 连接 9 V 电源 (不随货供应)。
- 3 **Footswitch** – 打开和关闭效果。当踏板开启时, LED 灯亮。当其关闭时, 踏板工作在真正的旁通。
- 4 **Fuzz** – 调节失真量。
- 5 **Volume** – 当踏板开启时, 调节输出电平。
- 6 **Tone** – 调节高频曲线量获得更加明亮或圆润的声音。

tc electronic

EN

ES

FR

DE

PT

IT

JP

CN

Battery Replacement

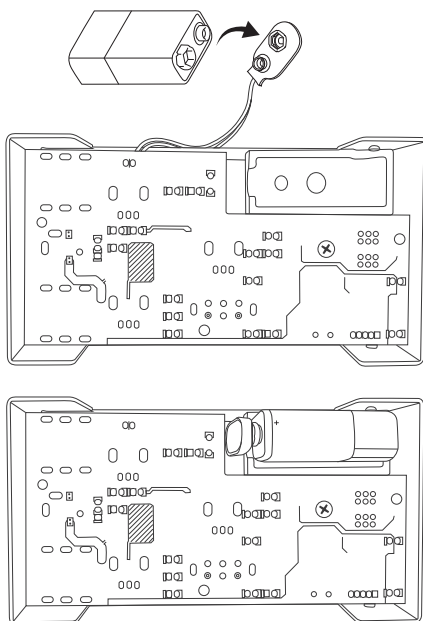

Storage

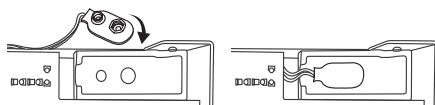

Specification

Connectors

Input	¼" TS, unbalanced
Impedance	>800 kΩ
Output	¼" TS, unbalanced
Impedance	1 kΩ
Power input	Standard 9 V DC, center negative, >100 mA
Battery option	Internal 9 V battery connector
Current consumption	<15 mA

Physical

Dimensions (H x W x D)	58 x 74 x 132 mm (2.3 x 2.9 x 5.2")
Weight	0.5 kg (1.1 lbs)

LEGAL DISCLAIMER

Music Tribe accepts no liability for any loss which may be suffered by any person who relies either wholly or in part upon any description, photograph, or statement contained herein. Technical specifications, appearances and other information are subject to change without notice. All trademarks are the property of their respective owners. Midas, Klark Teknik, Lab Gruppen, Lake, Tannoy, Turbosound, TC Electronic, TC Helicon, Behringer, Bugera, Oberheim, Auratone and Coolaudio are trademarks or registered trademarks of Music Tribe Global Brands Ltd. © Music Tribe Global Brands Ltd. 2021 All rights reserved.

LIMITED WARRANTY

For the applicable warranty terms and conditions and additional information regarding Music Tribe's Limited Warranty, please see complete details online at musictribe.com/warranty.

NEGACIÓN LEGAL

Music Tribe no admite ningún tipo de responsabilidad por cualquier daño o pérdida que pudiera sufrir cualquier persona por confiar total o parcialmente en la descripción, fotografías o afirmaciones contenidas en este documento. Las especificaciones técnicas, imágenes y otras informaciones contenidas en este documento están sujetas a modificaciones sin previo aviso. Todas las marcas comerciales que aparecen aquí son propiedad de sus respectivos dueños. Midas, Klark Teknik, Lab Gruppen, Lake, Tannoy, Turbosound, TC Electronic, TC Helicon, Behringer, Bugera, Oberheim, Auratone y Coolaudio son marcas comerciales o marcas registradas de Music Tribe Global Brands Ltd. © Music Tribe Global Brands Ltd. 2021 Reservados todos los derechos.

GARANTÍA LIMITADA

Si quiere conocer los detalles y condiciones aplicables de la garantía así como información adicional sobre la Garantía limitada de Music Tribe, consulte online toda la información en la web musictribe.com/warranty.

DÉNI LÉGAL

Music Tribe ne peut être tenu pour responsable pour toute perte pouvant être subie par toute personne se fiant en partie ou en totalité à toute description, photographie ou affirmation contenue dans ce document. Les caractéristiques, l'apparence et d'autres informations peuvent faire l'objet de modifications sans notification. Toutes les marques appartiennent à leurs propriétaires respectifs. Midas, Klark Teknik, Lab Gruppen, Lake, Tannoy, Turbosound, TC Electronic, TC Helicon, Behringer, Bugera, Oberheim, Auratone et Coolaudio sont des marques ou marques déposées de Music Tribe Global Brands Ltd. © Music Tribe Global Brands Ltd. 2021 Tous droits réservés.

GARANTIE LIMITÉE

Pour connaître les termes et conditions de garantie applicables, ainsi que les informations supplémentaires et détaillées sur la Garantie Limitée de Music Tribe, consultez le site Internet musictribe.com/warranty.

HAFTUNGSAUSSCHLUSS

Music Tribe übernimmt keine Haftung für Verluste, die Personen entstanden sind, die sich ganz oder teilweise auf hier enthaltene Beschreibungen, Fotos oder Aussagen verlassen haben. Technische Daten, Erscheinungsbild und andere Informationen können ohne vorherige Ankündigung geändert werden. Alle Warenzeichen sind Eigentum der jeweiligen Inhaber. Midas, Klark Teknik, Lab Gruppen, Lake, Tannoy, Turbosound, TC Electronic, TC Helicon, Behringer, Bugera, Oberheim, Auratone und Coolaudio sind Warenzeichen oder eingetragene Warenzeichen der Music Tribe Global Brands Ltd. © Music Tribe Global Brands Ltd. 2021 Alle Rechte vorbehalten.

BESCHRÄNKTE GARANTIE

Die geltenden Garantiebedingungen und zusätzliche Informationen bezüglich der von Music Tribe gewährten beschränkten Garantie finden Sie online unter musictribe.com/warranty.

LEGAL RENUNCIANTE

O Music Tribe não se responsabiliza por perda alguma que possa ser sofrida por qualquer pessoa que dependa, seja de maneira completa ou parcial, de qualquer descrição, fotografia, ou declaração aqui contidas. Dados técnicos, aparências e outras informações estão sujeitas a modificações sem aviso prévio. Todas as marcas são propriedade de seus respectivos donos. Midas, Klark Teknik, Lab Gruppen, Lake, Tannoy, Turbosound, TC Electronic, TC Helicon, Behringer, Bugera, Oberheim, Auratone e Coolaudio são marcas ou marcas registradas do Music Tribe Global Brands Ltd. © Music Tribe Global Brands Ltd. 2021 Todos direitos reservados.

GARANTIA LIMITADA

Para obter os termos de garantia aplicáveis e condições e informações adicionais a respeito da garantia limitada do Music Tribe, favor verificar detalhes na íntegra através do website musictribe.com/warranty.

DISCLAIMER LEGALE

Music Tribe non si assume alcuna responsabilità per eventuali perdite subite da qualsiasi persona che faccia affidamento in tutto o in parte su qualsiasi descrizione, fotografia o dichiarazione qui contenuta. Le specifiche tecniche, l'aspetto e altre informazioni sono soggette a modifiche senza preavviso. Tutti i marchi sono di proprietà dei rispettivi proprietari. Midas, Klark Teknik, Lab Gruppen, Lake, Tannoy, Turbosound, TC Electronic, TC Helicon, Behringer, Bugera, Oberheim, Auratone e Coolaudio sono marchi o marchi registrati di Music Tribe Global Brands Ltd. © Music Tribe Global Brands Ltd. 2021 Tutti diritti riservati.

GARANZIA LIMITATA

Per i termini e le condizioni di garanzia applicabili e ulteriori informazioni sulla garanzia limitata di Music Tribe, vedere i dettagli completi online su musictribe.com/warranty.

EN

ES

FR

DE

PT

IT

法的放棄

ここに含まれる記述、写真、意見の全体または一部に依拠して、いかなる人が損害を生じさせた場合にも、Music Tribe は一切の賠償責任を負いません。技術仕様、外観およびその他の情報は予告なく変更になる場合があります。商標はすべて、それぞれの所有者に帰属します。Midas、Klark Teknik、Lab Gruppen、Lake、Tannoy、Turbosound、TC Electronic、TC Helicon、Behringer、Bugera、Oberheim、Auratone および Coolaudio は Music Tribe Global Brands Ltd. の商標または登録商標です。© Music Tribe Global Brands Ltd. 2021 無断転用禁止。

限定保証

適用される保証条件と Music Tribe の限定保証に関する概要については、オンライン上 musictribe.com/warranty にて詳細をご確認ください。

法律声明

对于任何因在此说明书提到的全部或部分描述、图片或声明而造成的损失，MUSIC TRIBE 不负任何责任。技术参数和外观若有更改，恕不另行通知。所有的商标均为其各自所有者的财产。Midas, Klark Teknik, Lab Gruppen, Lake, Tannoy, Turbosound, TC Electronic, TC Helicon, Behringer, Bugera, Oberheim, Auratone 和 Coolaudio 是 Music Tribe Global Brands Ltd. 公司的商标或注册商标。© Music Tribe Global Brands Ltd. 2021 版权所有。

保修条款

有关音乐集团保修的适用条款及其它相关信息，请登陆 musictribe.com/warranty 网站查看完整的详细信息。

JP

CN

FEDERAL COMMUNICATIONS COMMISSION COMPLIANCE INFORMATION

TC Electronic

RUSTY FUZZ

Responsible Party Name: **Music Tribe Commercial NV Inc.**

Address: **5270 Procyon Street,
Las Vegas NV 89118,
United States**

Phone Number: **+1 702 800 8290**

RUSTY FUZZ

This equipment has been tested and found to comply with the limits for a Class B digital device, pursuant to part 15 of the FCC Rules. These limits are designed to provide reasonable protection against harmful interference in a residential installation. This equipment generates, uses and can radiate radio frequency energy and, if not installed and used in accordance with the instructions, may cause harmful interference to radio communications. However, there is no guarantee that interference will not occur in a particular installation. If this equipment does cause harmful interference to radio or television reception, which can be determined by turning the equipment off and on, the user is encouraged to try to correct the interference by one or more of the following measures:

- Reorient or relocate the receiving antenna.
- Increase the separation between the equipment and receiver.
- Connect the equipment into an outlet on a circuit different from that to which the receiver is connected.
- Consult the dealer or an experienced radio/TV technician for help.

This device complies with Part 15 of the FCC rules. Operation is subject to the following two conditions:

- (1) this device may not cause harmful interference, and
- (2) this device must accept any interference received, including interference that may cause undesired operation.

Important information:

Changes or modifications to the equipment not expressly approved by Music Tribe can void the user's authority to use the equipment.



Hereby, Music Tribe declares that this product is in compliance with Directive 2014/30/EU, Directive 2011/65/EU and Amendment 2015/863/EU, Directive 2012/19/EU, Regulation 519/2012 REACH SVHC and Directive 1907/2006/EC.

Full text of EU DoC is available at <https://community.musictribe.com/>

EU Representative: Music Tribe Brands DK A/S
Address: Ib Spang Olsens Gade 17, DK - 8200 Aarhus N, Denmark