

## Professional Powered Speakers

# EUROLIVE B1800D-PRO B1500D-PRO

### High-Performance Active 1400-Watt 18"/15" PA Subwoofer With Built-In Stereo Crossover

- High-performance 1400-Watt powered subwoofer for PA applications
- Powerful 18"/15" long-excursion transducer with high temperature voice coil provides incredibly accurate and pulse-pounding bass
- Extremely high sound pressure level (126 dB half space 1 W @ 1 m)
- Precise reproduction of ultra-low frequencies (35 – 150 Hz) for "bulletproof" punch and impact
- State-of-the-art 1400-Watt Class-D amplifier with comprehensive over-excursion, thermal and clip limit protection
- Built-in active stereo crossover provides high-pass filtered outputs for full-range loudspeakers
- Tunable and switchable Bass Boost plus Phase switch for ultimate low-frequency performance
- Variable High Cut control for perfect sound alignment
- Subwoofer Level control to adjust the balance between subwoofer and the full-range speakers
- Power, Signal and Clip LEDs for perfect monitoring
- Intelligent limiter for maximum sound performance and woofer protection



Our EUROLIVE B1500D-PRO and B1800D-PRO active subwoofers are destined to become the new standard in low-frequency reproduction. Packed with an incredible array of truly professional features, these brutes provide extreme levels of low-end punch, with the kind of definition and clarity typically reserved for much larger systems.

Class-D amplifiers (with switch-mode power supplies) drive the custom-designed low frequency drivers for sonically optimized output. And the best part of all—these new B1800D-PRO and B1500D-PRO are powered by 1400 Watts—in your choice of 18" and 15" versions. As always, the speakers are made by BEHRINGER in our own factory.

Put simply, these active subwoofers provide massive connectivity options and are easy set up—and our no-compromise design means you get amazingly-deep,

chest-pounding bass that'll keep the party going all night long. They'll add serious bottom-end to your active full-range speaker system.

#### What is Class-D Technology?

Instead of operating relatively continuously like Class AB circuits, Class-D amps switch on and off thousands of times per second, delivering power only when needed. In other words, the amplifier is either fully on or fully off, which significantly reduces power losses from the output devices given off as heat. Our no-compromise design means the B1500D-PRO and B1800D-PRO will deliver full power with incredible fidelity all night long, without the need for lengthy rest cycles. When used in conjunction with switching-mode power supplies, our "green technology" Class-D amplifiers provide tremendous dynamic punch and superior fidelity.

*Continued on next page*



# EUROLIVE B1800D-PRO B1500D-PRO

- Internal switch-mode power supply for noise-free audio, superior transient response and very low power consumption
- Pole socket for mounting with commercial spacer poles
- Ergonomically shaped handles for easy transport
- Rugged steel grill for optimal speaker protection
- High-quality components and exceptionally rugged construction ensure long life
- Conceived and designed by BEHRINGER Germany

## Custom-Designed Transducers

The transducers (woofers and tweeters) are the only part of a sound system you actually hear, so we don't cut any corners here. We use the most advanced, computer-based Klippel and MLSSA systems in our design and manufacturing process, ensuring that our transducers provide optimal performance within their specified application. We custom-design and build our transducers from scratch; winding the voice coils, processing the paper pulp into cones—and even machining the backplates. This enables us to control the quality, and frankly, to make better components.

## Take Control

The B1500D-PRO and B1800D-PRO feature balanced XLR inputs and outputs, as well as balanced XLR THRU jacks for connecting additional enclosures. A BOOST FREQUENCY knob targets a boost frequency between 45 Hz and 90 Hz. Flick the BOOST switch to give your selected frequency a +6 dB boost.

These subs also feature a HIGH CUT dial to control the upper corner frequency for the subwoofer's amplifier. The HIGH-CUT dial affects only the signals directed to the subwoofer. The Output A and B sockets have a fixed 100 Hz low-cut filter to facilitate connecting full-range active loudspeakers. A LEVEL knob controls the input gain, and the PHASE switch reverses output phase to compensate for frequency cancellation between the subwoofer and satellite speakers. LEDs show operational status at a glance, including power, signal present and input overloads.

## Which Speaker Do I Need?

As you have probably noticed, we make these subwoofers in two different woofer sizes. Which one is right for you? An 18" woofer has 44% more surface area with which to move air than a 15". If you're engineering sound for a small jazz combo in a small club, the B1500D-PRO might be all the speaker you need. If you need to provide pounding techno sounds to a standing room only nightclub, the B1800D-PRO might be the better choice.

*Continued on next page*

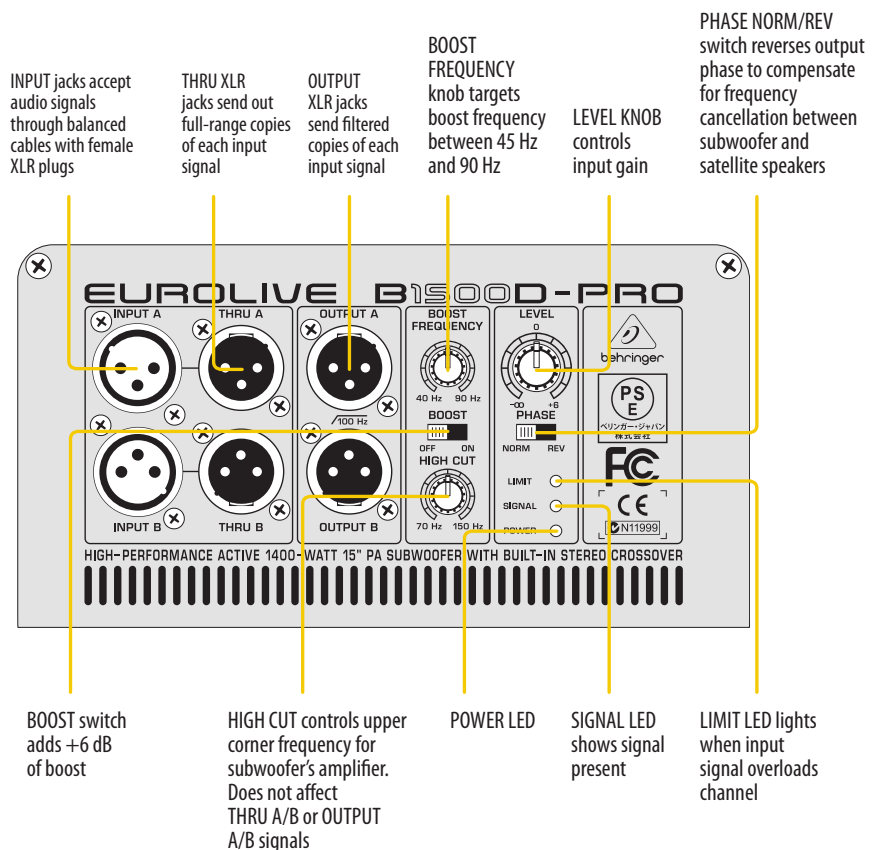

# EUROLIVE B1800D-PRO B1500D-PRO

## Value

Plenty of power, amazing sound, tough durability and affordability—you get it all with the B1500D-PRO and B1800D-PRO. Plus, you get tremendous

tone-sculpting capability, thanks to an impressive array of filtering options. Check out these high-tech heavy hitters at your nearest BEHRINGER dealer and let them redefine your low end.

## Single Subwoofer with Stereo Mains

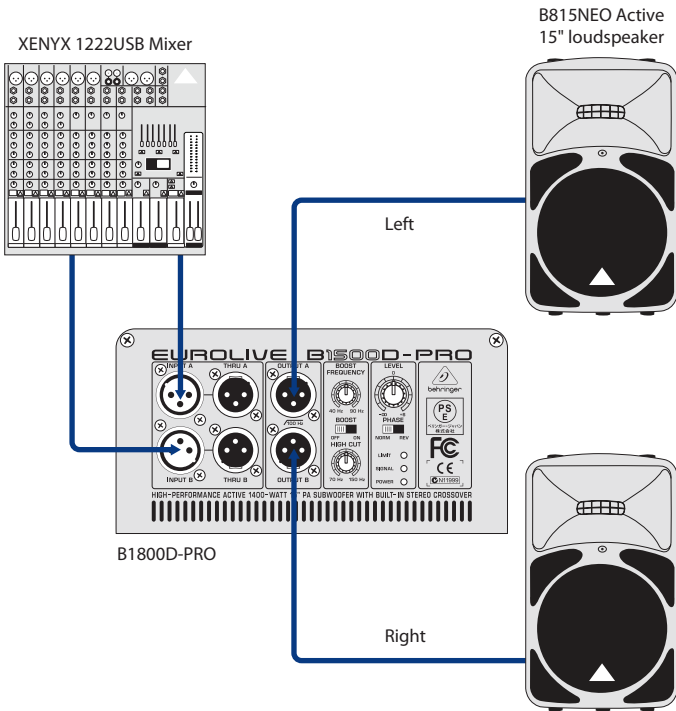

## Active Stack Application

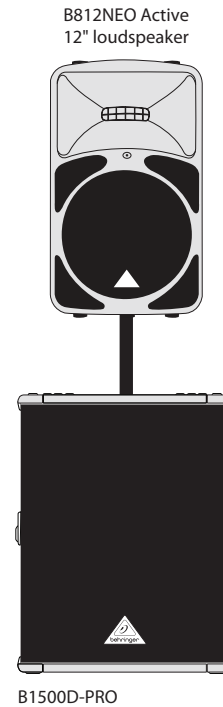

## Dual Subwoofers with Stereo Mains

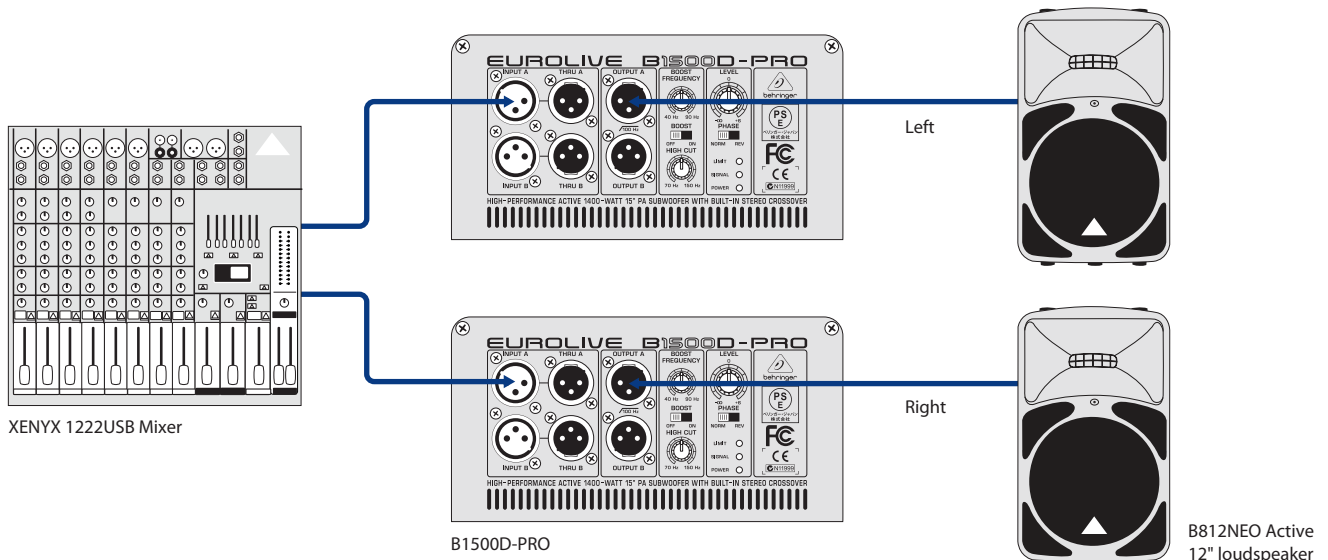

# EUROLIVE

## B1800D-PRO

## B1500D-PRO

### Specifications

#### B1800D-PRO/B1500D-PRO

##### Amplifier Power Output

RMS	1000 W @ 6 Ω
Peak	1400 W @ 6 Ω

##### Audio Inputs

INPUT A / B	XLR (servo-balanced)
Sensitivity	+4 dBu @ 0 dB (center position) for full rated power
Clipping	10 V RMS (+22 dBu)
Input impedance	10 kΩ unbalanced, 20 kΩ balanced

##### Audio Outputs

THRU A / B	XLR (servo-balanced)
OUTPUT A / B	XLR (servo-balanced)
High-pass filter	100 Hz, Butterworth, 18 dB slope

##### Controls

LEVEL	-∞ to +6 dB
BOOST FREQUENCY	40 Hz - 90 Hz; Q = 1; +10 dB
BOOST	dip switch
HIGH CUT	Variable-frequency high-cut filter, 70 Hz - 150 Hz, Butterworth, 24 dB slope
PHASE	0° or 180° phase reverse switch

#### B1800D-PRO

##### Loudspeaker System Data

Frequency Response	32 Hz - 200 Hz (-10 dB) 40 Hz - 150 Hz (+/-3 dB)
Signal-to-Noise (20 Hz to 20 KHz)	> 100 dBA
Sound pressure level	max. 129 dB @ 1 m
Woofers	18 inch, 6 Ω
Limiter	VCA CLIP Limiter, fixed
LIMIT LED	Red
SIGNAL LED	Yellow
POWER LED	Blue

#### B1500D-PRO

##### Loudspeaker System Data

Frequency Response	32 Hz - 200 Hz (-10 dB) 45 Hz - 150 Hz (+/-3 dB)
Signal-to-Noise (20 Hz to 20 KHz)	> 100 dBA
Sound pressure level	max. 128 dB @ 1 m
Woofers	15 inch, 6 Ω
Limiter	VCA CLIP Limiter, fixed
LIMIT LED	Red
SIGNAL LED	Yellow
POWER LED	Blue

#### B1800D-PRO/B1500D-PRO

##### Circuit Protection

Amplifier Protection	Full short circuit, thermal, overcurrent, DC protection.
Load Protection	Turn-on/off muting, DC

##### Power Supply

##### Voltage (Fuses)

USA / Canada	120 V~, 60 Hz (T 12 A H 250 V)
UK / Australia	240 V~, 50 Hz (T 6.3 A H 250 V)
Europe	230 V~, 50 Hz (T 6.3 A H 250 V)
Japan	100 V~, 50-60 Hz (T 12 A H 250 V)
Power consumption	max. 1200 Watts
Mains connection	Standard IEC receptacle

#### B1800D-PRO

##### Dimensions/Weight

Dimensions (H x W x D)	appr. 27.3 x 21.6 x 21.7" appr. 692 x 547 x 552 mm
Weight	appr. 119 lbs / 54 kg

#### B1500D-PRO

##### Dimensions/Weight

Dimensions (H x W x D)	appr. 23.8 x 18.3 x 20.9" appr. 605 x 465 x 530 mm
Weight	appr. 92.6 lbs / 42 kg

Please note these specifications are preliminary and conceptual in nature, and as such are subject to change as product development progresses. This information is supplied for market research purposes only and is not to be made public in any manner. This document is solely the property of The MUSIC Group, or one of its subsidiaries, and must be surrendered upon request of the owner.

For service, support or more information contact the BEHRINGER location nearest you:

**Europe**  
MUSIC Group Services UK  
Tel: +44 156 273 2290  
Email: CARE@music-group.com

**USA/Canada**  
MUSIC Group Services NV Inc.  
Tel: +1 702 800 8290  
Email: CARE@music-group.com

**Japan**  
MUSIC Group Services JP K.K.  
Tel.: +81 3 6231 0454  
Email: CARE@music-group.com

Technical specifications and appearances are subject to change without notice and accuracy is not guaranteed. BEHRINGER is part of the MUSIC Group (music-group.com). All trademarks are the property of their respective owners. MUSIC Group accepts no liability for any loss which may be suffered by any person who relies either wholly or in part upon any description, photograph or statement contained herein. Colors and specifications may vary from actual product. MUSIC Group products are sold through authorized fulfillers and resellers only. Fulfillers and resellers are not agents of MUSIC Group and have absolutely no authority to bind MUSIC Group by any express or implied undertaking or representation. This manual is copyrighted. No part of this manual may be reproduced or transmitted in any form or by any means, electronic or mechanical, including photocopying and recording of any kind, for any purpose, without the express written permission of MUSIC Group IP Ltd. ALL RIGHTS RESERVED. © 2012 MUSIC Group IP Ltd. Trident Chambers, Wickhams Cay, P.O. Box 146, Road Town, Tortola, British Virgin Islands. 985-10000-00450